

- AMERICAN ALUMINUM FORDY - EDGAR & BESSIE ATKINS -

HALTON ROAD
CRACKY
WATER SOFT
WOODCUFF ROAD
M3-45M AD EHT
75.0

- CHRISTINE JONES -

- CHARLES & BARBARA CARTER -

- C.D. & MARGA BISHOP -

FILED
GREENVILLE CO. S.C.
JAN 7 4 40 PM '85
DONNIE S. TANKERSLEY
R.M.C.

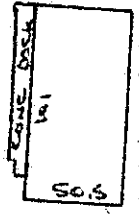
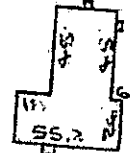
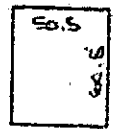

EXISTING BLOSS

- 3.94 AC -

- 6.44 AC - TOT.

- 2.50 AC -

N68-06E-10P
168.2

N70-21E
363.0

227.2
584-31W

N24-28W
563.3 TOT
245.3
318.0

N67-09E
272.0

S68-43E
171.65

733.7
S24-30E

317.55
S24-30E

24 37.5
475 TO
HALTON ROAD

368.0
327.3

WOODCUFF WATER TRAP

ROAD (S.C. MAY 1980)

SURVEY FOR
METROMONT MATERIALS
NEAR GREENVILLE, GREENVILLE COUNTY, S.C.
SCALE: 1"=100' JULY 1984
REV 12 NOV 1984

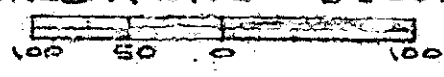

I Certify that the Ratio of Precision of the Field survey is 1/7000+ as shown hereon and that the area determined by D.M.D. Method of Area Calculations.

R. B. P...
RCS # 1952

CAROLINA SURVEYING Co.
112 MAINLY ST.
GREENVILLE, S.C.

THIS PLAT IS NOT A SUBDIVISION AS DEFINED BY THE GREENVILLE COUNTY SUBDIVISION REGULATIONS.
1.17.1985
Chairman, Secretary, or Director of Planning.
Greenville County Planning Commission

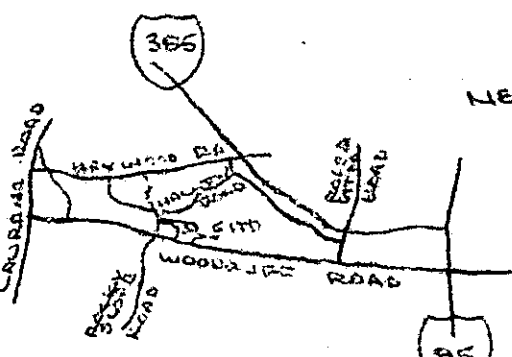

LOCATION MAP NO SCALE

11-F-3 20211

279-78
2 JA 7 85 441
5.0001

260-1-16.6 & 260-1-73

73806